

The essentials of imaging

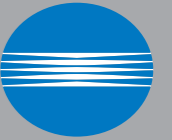

KONICA MINOLTA



**SYDNEY**

22 Giffnock Ave  
North Ryde NSW 2113

**BRISBANE**

64 Brookes Street  
Bowen Hills QLD 4006

**MELBOURNE**

887 Monash Highway  
Rowville VIC 3178

**ADELAIDE**

255 Gilbert Street  
Adelaide SA 5000

**CANBERRA**

78 Barrier Street  
Fyshwick ACT 2609

**PERTH**

161 Great Eastern Highway  
Belmont WA 6104

Sales and Service Toll Free

1800 789 389

[www.konicaminolta.com.au](http://www.konicaminolta.com.au)



KONICA MINOLTA

**Konica Minolta 8050**

DIGITAL COLOUR IMAGING SYSTEM

Konica Minolta Business Solutions Australia Pty Limited  
ABN 50 001 065 096

KM5631

Imagine being able to print more than 50 colour pages per minute ...and do it at a cost that's a breakthrough in affordability. Now, with the 8050, it's all at your fingertips.

This superb new machine produces fast, short-run colour documents as either direct colour copies, or as prints from a Desktop PC.

## COLOUR THAT'S FAST. COLOUR THAT'S AFFORDABLE. COLOUR AT MORE THAN 50 PAGES PER MINUTE.

Which means you can produce your marketing proposals, reports, brochures, flyers, posters and presentation handouts – in brilliant colour, in-house.

So you'll get superb, controllable quality, and gain huge savings in time and money.

With the 8050, you'll get superb, consistent colour every time.



THE KONICA MINOLTA 8050

## GAIN MAXIMUM EFFICIENCY, WITH HIGH END COLOUR PRODUCTION QUALITY

### HIGH SPEED PRINTING AT 50PPM IN FULL COLOUR AND BLACK & WHITE

A fast output speed of 50 copies or prints per minute provides the perfect platform for high-volume production and lets you print even the most complex documentation in time for your important board meeting or client presentation.

### INTELLIGENT NETWORKING\* ADVANCED SOFTWARE

Combined with the latest EFI Fiery software, the 8050 gives you more control to build, manipulate and manage documents.

You will be able to work more efficiently and produce high quality documents. By connecting the 8050 to your LAN/WAN you can harness the power of high-speed network printing.

### SUPPORTS CUSTOM PAPER STOCK

The 8050 features industry-leading support for paper up to A3+ (330 x 487mm) and up to 256gsm stock (including gloss, card and tab stock) as well as a generous maximum paper capacity of 4,250 sheets. The 8050 is designed to have the paper handling flexibility that high speed, high-volume colour printing demands.



### A NEW GENERATION IN COLOUR

Konica Minolta's exclusive satin finish has been designed for the new generation of business colour. This new generation colour finish is:

- easy-to-read and non-reflective
- scratch resistant
- easy-to-write-on
- able to reproduce natural colour images

Gain a contemporary image for your company with new business colour documents.

### FINISHING FOR A TRULY PROFESSIONAL OUTPUT

With the 8050's range of finishing options you can fold, staple, hole-punch and trim your documents. Impress everyone with sophisticated finishing similar to what only a professional printer could produce in the past. Options such as single-position or booklet stapling, 2 or 4-hole punching, or automatic DL letter folding are available.

\* Optional IP-901 print controller required.



### HIGH SPEED PRODUCTIVITY WITH CONSISTENT QUALITY

The 8050 delivers high quality documents at 50 pages per minute in A4 colour or black and white. Designed for excellent consistency, whether it is from copy 1-1000 your prints or copies from the 8050 will remain the same. This consistency is due to the latest Konica Minolta single pass tandem technology. And with four drums and a straight paper path arranged vertically, it's also a highly compact and space saving design.

### COLOUR AT A COST PER PAGE THAT'S HARD TO IMAGINE

When connected as a work group multi-function printer/copier, the 8050 outperforms the opposition.

Traditional colour laser printers and copiers can cost up to 10 times the cost per page that the 8050 delivers. Expensive consumable costs and service agreements increase the total cost of ownership (TCO) of your office stand-alone printers.

### REVOLUTIONARY DESIGN GIVES YOU BACK VALUABLE FLOOR SPACE

With a vertical tandem print engine, the main body is extremely compact: 794 (W) x 889 (D), x 1056 (H) and lighter than most equivalent models.

### ADVANCED TONER TECHNOLOGY™

Konica Minolta's Digital Colour Polymerised Toner™ sharpens text, clarifies images and improves virtually every aspect of image output quality.

Advanced Continuous Toner™ (ACT™) is Konica Minolta's new toner replacement system that enables you to replace the toner while the 8050 is running prints or copies. With ACT™, long, uninterrupted in-house colour printing is easy.



## HARNESS THE POWER OF EFI'S FIERY CONTROL FOR ALL YOUR DOCUMENT MANAGEMENT

The 8050's optional high performance printer controller (IP-901) ensures you can achieve reliable network integration, allowing you and your team to produce print jobs quickly and easily from your desktop.

### PRINT DOCUMENTS IN MINUTES, NOT HOURS

A colour printer/copier as fast and as powerful as the 8050 demands a printer controller that can keep up with its 50ppm output speed. Specifically tailored to the high-end production arena, the Konica Minolta Fiery®-based IP-901 is the powerhouse that will take your office into the future.

### ADVANCED TECHNOLOGY

Fiery System version 5.5™ software takes the new Konica Minolta IP-901 server to the next level, with the latest EFI innovations that make it easy to create, print, scan and manage high quality documents. Fiery System 5.5™ includes enhanced variable data printing capabilities, applications for colour management, networking, scanning and remote job management.



(IP-901 pictured)



## COMBINE THE KONICA MINOLTA IP-901 PRINTER CONTROLLER OPERATING SYSTEM WITH ENHANCED SOFTWARE FOR MAXIMUM DELIVERY AND FLEXIBILITY

### WORKFLOW MANAGEMENT

Set your digital workflow in action with the latest EFI software such as the latest versions of Command Workstation™, Doc Builder™ and Fiery™ Freeform™.

### COMMAND WORKSTATION™ MAKES LIFE EASY

Command WorkStation is designed to make centralised print job management easy. It automatically identifies Fiery servers on your network and offers new customisation options so you can choose how to display information about connected Fiery servers more efficiently. It sets the standard for conveniently managing and manipulating digital print jobs on the network.

#### FEATURES:

- Three levels of security for administration and printing
- Extensive job controls
- Thumbnail and full-screen job previews for remote job management
- Load balancing available to maximize printing resources\*
- FreeForm Master Preview
- Booklet Maker Option
- Legacy Fiery Support
- Command Workstation LE for Mac users
- Manipulate and manage jobs and job settings
- Display, save, print or delete the job log
- Download jobs directly to the Fiery
- Archiving of files for accessing and re-printing later
- Job Log window for detailed information on every print job
- Customisable User Interface can be tailored to workflow requirements and operator skill level

\* Optional

## ACHIEVE MORE WITH KONICA MINOLTA'S POWERFUL AND AFFORDABLE BUSINESS TECHNOLOGY TOOLS

### FIERY® DOCBUILDER™ TECHNOLOGY

DocBuilder™ brings powerful and affordable server-based imposition technology to virtually anyone who publishes. The easy-to-use 'what you see is what you get' (WYSIWYG) graphical user interface simplifies creation of imposed print jobs and gang ups on digital colour printing devices.

### DOCBUILDER™ PRO (OPTIONAL)

DocBuilder™ Pro features advanced capabilities including: Job previews at a pre-RIP level, powerful imposition capabilities, templates for custom and re-occurring formats facilitate consistency and pre-flighting capabilities allowing pre-production error checking. It is also platform, application, and file format independent.

#### DOCBUILDER™ FEATURES:

- Continuous Print
- Error-Free Printing
- RIP-While-Print
- Save-Fast Printing
- Reverse Order Printing
- Auto-Duplexing
- Electronic Collation
- PitStop technology
- Thumbnail Preview and Job Merging

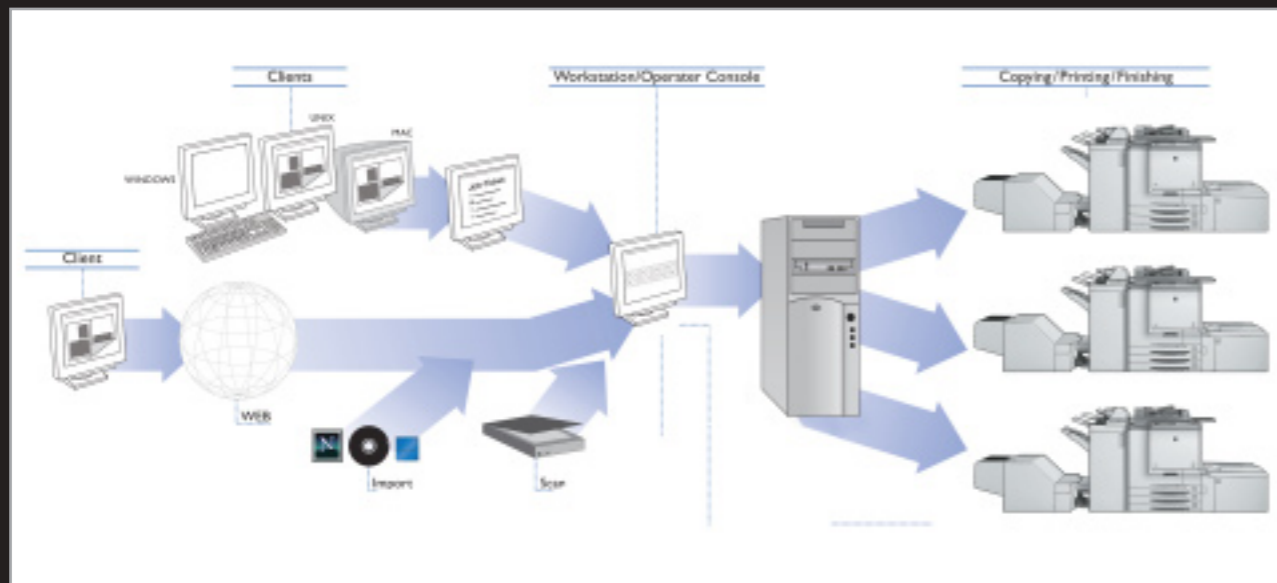

### ACCELERATED SET-UP WITH FIERY NETWISE™

Accelerate setup and achieve seamless connectivity on all popular network environments with Fiery NetWise™. To the standard Ethernet connection, Fiery NetWise™ adds Web connectivity for printing via the Internet. NetWise™ also offers the ability to perform many administrative tasks through email, such as submitting jobs to different Fiery servers, cancelling them, and sending scanned images to remote locations.



Easy to use document management tools

## WEB-BASED APPLICATIONS GIVE YOUR 8050 MORE CONTROL THAN EVER BEFORE

### NETWORK SCANNING WITH FIERY® REMOTE SCAN 5.0™

Scanning Support Fiery® Remote Scan™ incorporates the Fiery controller as a key element of network scanning. Scans can be stored on the Fiery's hard drive. Scans can then be retrieved via the Fiery Web Tools™ utility, local Fiery interface (FACI), and TWAIN plug-in.



#### SCAN TO EMAIL IN COLOUR

Save valuable time by scanning materials at the console and sending them directly as an email attachment. Simply input the recipient's email address using the touch panel and send high quality images at once.

#### SCAN TO FTP IN COLOUR

Convert scanned data into TIFF or PDF format files and forward them to your FTP server for downloading from any PC connected over your network.

#### SCAN TO HARD DISK DRIVE IN COLOUR

Scanning materials for archiving or for future use is now as easy as copying via the platen glass or the RADF at an incredible 37opm. You can scan and save data directly to the Fiery HDD.

## FAST, ACCURATE, PROFESSIONAL COLOUR



### POWERFUL COLOUR CONTROL TOOLS

Combining intelligent colour management software and digital colour polymerized toner the 8050 allows you to quickly and easily produce a wide range of jobs in precise, consistent colour.

### EASY TO LEARN. EASY TO USE. COLORWISE® 3.0

EFI's Fiery® colour management software adds flexibility and features that help users achieve the highest quality colour possible on their output devices and accurately simulate the output of other colour devices. Its easy-to-use colour adjustments make learning ColorWise easy.

#### FEATURES:

- Automatic PANTONE® colour matching
- Transparent handling of RGB, CMYK and spot colour data
- Colour correction on the fly

#### NEW FEATURES - VERSION 3.0:

- ColorCal™ provides high quality calibration using a copier's scanner
- Auto Grey Replacement automatically adjusts grey balance based on a measurement page placed on a copier's scanner
- Full (output GCR) is a CMYK simulation with user controllable black generation – it offers a better match to typical colour management systems

### KONICA MINOLTA'S UNIQUE DIGITAL COLOUR POLYMERIZED TONER™

Konica Minolta's new Digital Colour Polymerized Toner™ provides superior halftone definition and better solid fills. This unique technology produces toner particles that are uniform in shape. For printing, this results in fine lines and text that are clearer and achieves remarkable quality gradation in pictures and illustrations. Konica Minolta's Digital Colour Polymerized Toner™ is also environmentally friendly, reducing emissions of CO<sub>2</sub>, SO<sub>x</sub> and NO<sub>x</sub> during copying and printing.

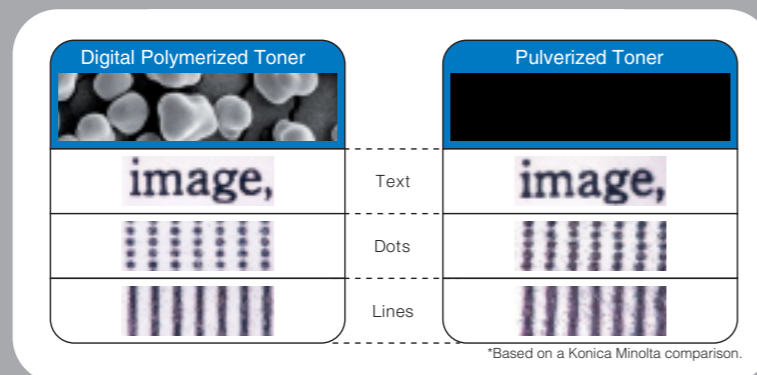

## CREATE COMPLEX DOCUMENTS WITH EASE

The 8050 is compatible with a wide variety of media such as thick paper used for presentation covers and tab stock. You can also select from a range of paper sizes and types including gloss stock and up to A3 wide for prints or copies that include crop marks or for enlarging smaller difficult to read charts.

The 8050 offers two finisher options – a multi position Stapler finisher (FS-115) and a booklet-finisher (FS-215) for creating professional booklets. The booklet finisher option also offers 2 and 4 hole punching for a variety of finishing needs.

### REVERSE AUTOMATIC DOCUMENT FEEDER (RADF)

The sheet through RADF performs high-speed scanning at 600 dpi resolution. The RADF also supports mixed-size originals in a single run.

### HIGH-SPEED STACKLESS DUPLEXING

The 8050 optional Duplexing Document Feeder gives you stackless duplex copying. You can also double-side colour copies virtually as fast as single sided, even make 2-in-1 and 4-in-1 copies.

### STAPLING & HOLE-PUNCHING

The optional booklet-finisher FS-115 offers multiple stapling positions, sorting and hole punching for binding. The FS-215 also offers centre-folding and tri-folding capabilities to produce flyers and direct mailers ready for the envelope.



### FLEXIBLE MEDIA SUPPORT

The Konica Minolta 8050 can easily handle a wide selection of media. The following stock is accepted:

#### Original Size

max.A3 (max. 303 x 438 mm)

#### Paper Sizes

A5R – A3+ (max. 330 x 488mm) from trays 1,2,3

A6R – A3+ (max. 330 x 488mm) from bypass + LCT

#### Paper Weights

64 – 209gsm (trays 1,2,3);

64 – 256gsm (from bypass and LCT);

Duplex A5 – A3+ (330 x 488)

#### Paper Supply

3 x 500 sheets (universal) + 250 sheets (bypass)

Optional: 2,500 sheets (LCT); Total 4,250 sheets (90gsm)

### LARGE CAPACITY TRAY\*

Large capacity tray stacks 2,500 sheets and supports up to 256gsm.

\*Air blowing with fan adopted for paper separation auxiliary.

## COST-EFFECTIVENESS, QUALITY & FLEXIBILITY KEY TO SNAP FRANCHISE SELECTING KONICA MINOLTA'S 8050 COLOUR IMAGING SYSTEM

Sydney based, SNAP Printing's North Ryde office is quick to list reasons for being the first Australian company to take delivery of a Konica Minolta 8050 digital colour imaging system.

SNAP is happy to talk about the system – especially in light of the 15,000 prints produced in the first week.

"The Konica Minolta 8050 appears ideal for short run, high-quality, colour print jobs," SNAP says. "Because toner is laid down on a single pass and print registration is better."

On one job, registration creep was less than 1mm on 500 prints, duplexed, allowing for easy cropping on full-page bleed.

Print registration according to SNAP, has always been a problem with Digital Print Systems.

SNAP is also impressed with the 8050's ability to produce solid 'block-colour' – one more thing digital colour systems have not always delivered.

Another plus has been the 8050's automatic colour matching abilities. While the system can be manually calibrated to reproduce precise corporate PMS™ colours, the 8050 automatically reproduced a corporate logo (in process blue) – courtesy of EFI's Colourwise 3.0™ software bundled with the machine's printer controller.



"Because the 8050 is so easy to use, we don't need specialist staff to produce excellent results," SNAP says. "This will also help us keep our costs lower."

With other advantages – such as the ability to handle some of the largest sheet sizes in the digital print market today, add gloss to finished output and scan jobs directly into the system (off the glass) – SNAP believes it will quickly reach 50,000 impressions a month in quality, short-run print jobs.

"We selected the 8050 digital colour imaging system because it's easy to use, reliable, robust and extremely cost effective compared with other digital colour printers currently available. The 8050 allows us to better address high-quality, shorter and targeted colour production jobs."

SNAP Printing, North Ryde, Sydney



THE KONICA MINOLTA 8050

# TECHNICAL SPECIFICATIONS KONICA MINOLTA 8050

<b>Type</b>	Console colour laser printer/copier with fixed platen
<b>Print Technology</b>	Laser based tandem technology
<b>User Operation</b>	Touch sensitive display
<b>Memory Capacity</b>	Std. 128 MB (x4) Add. 256 MB (x4) Total 384 (x4) or 1,536 MB
<b>Original Size</b>	max.A3 (max. 303 x 438 mm)
<b>Paper Sizes</b>	A5R – A3+ (max. 330 x 488mm) from trays 1,2,3 A6R – A3+ (max. 330 x 488mm) from bypass + LCT
<b>Paper Weights</b>	64 – 209gsm (trays 1,2,3); 64 – 256g/m2 (from bypass and LCT); Duplex A5 – A3+ (330.2 x 482.6), paper weight: 64 – 209 gsm
<b>Paper Supply</b>	3 x 500 sheets (universal) + 250 sheets (bypass) Optional: 2,500 sheets (LCT); Total 4,250 sheets (90g/m2)
<b>Exit Tray</b>	150 sheets
<b>Print Quantity Selection</b>	1 – 9999
<b>Speed</b>	A4 = 51 ppm full colour, 51 ppm mono colour / b/w A3 = 27 ppm full colour, 27 ppm mono colour / b/w
<b>Resolution</b>	600 x 600 dpi (copy/scan)
<b>Halftones</b>	256
<b>Warm-up Time</b>	Approx. 7 minutes
<b>First Copy-Out Time</b>	Approx. 7.6 sec.A4 (colour), approx. 6.0 sec.A4 (b/w)
<b>Magnification</b>	Zoom 25 – 400 % in 0.1% increments
<b>Reductions</b>	0.866 / 0.816 / 0.707 / 0.500,
<b>Enlargements</b>	1.154 / 1.224 / 1.414 / 2.000
<b>Copy Functions</b>	Simplex, Duplex, Frame Erase, Proof & Print
<b>Image Manipulation Functions</b>	X/Y Zoom, Mirror Image, Copy Density (background, density, etc)
<b>Image Type (Originals)</b>	Text, Photo, Text & Photo, Printed Image, Map Mode, Photo Image Paper, Copy Paper, Inkjet Paper
<b>Special Functions</b>	Interrupt, Book Copy, 2-in-1, 4-in-1, 8-in-1, Booklet; Sheet/Cover Insertion (30 locations), Front/Back Cover; Stamp/Watermark*; Overlay*; etc.

\* Optional

<b>Colour Adjustment</b>	Hue, Saturation, Brightness, Sharpness, Contrast, Colour Balance, Density of R/G/B
<b>eKRDS</b>	Remote Diagnostics System which supports GSM and GPRS modems and secure e-mail communication with attachment (DES encoding available)
<b>Power Supply</b>	230 V / 15 A; 50 Hz
<b>Power Consumption</b>	Max. 3,400 Watt
<b>Dimensions (WxDxH)</b>	794 x 889 x 1,056 mm (mainbody) 2,213 x 889 x 1,181 mm (mainbody + DF-319 + FS-215 + LT-211)
<b>Weight</b>	313 kg (mainbody)

## Accessories

<b>Platen Cover (CV-131) RADF (DF-319)</b>	100 sheets (80g) A5 – A3, Paper weight: Single-sided 35 – 200 g/m2, Double-sided 50 – 200g/m2;OPM = 37 pages
<b>LCT (LT-211)</b>	2,500 sheets A4 (90g/m2); Paper sizes B5 – A3+ (wide size 330 x 488mm); Paper weight: 50 – 256g/m2;
<b>Staple Finisher (FS-115)</b>	Capacity: Non-staple 3,000 / staple mode 1,000 sheets; 3 positions / 50 sheets (80g/m2)
<b>Booklet Finisher (FS-215)</b>	Capacity: Non-staple 2,500 / staple mode 1,000 sheets; 4 positions / 50 sheets (80g/m2); Booklet: 20 sheets; Three fold mode for up to 3 sheets per set
<b>Punching Kit (PK-120)</b>	
<b>Post Inserter (PI-110)</b>	
<b>Trimmer Unit (TU-109)</b>	
<b>Memory</b>	4 x 256 MB (MU-412)
<b>Hard Disk (HD-106)</b>	Only for Watermarks and Stamp functions

## IP-901 Fiery Print Controller

<b>Print Speed (bw/c)</b>	51/51 ppm
<b>Resolution</b>	600 dpi
<b>Processor</b>	Intel Pentium IV, 2.0 GHz
<b>Memory</b>	512 MB; upgrade max. 1 GB
<b>Hard Drive</b>	60 GB
<b>Removable Media</b>	DVD-ROM; optional USB ZIP 250
<b>Compression</b>	ECT
<b>Page Description Language</b>	Adobe PS3
<b>Standard Fonts</b>	136
<b>Interface</b>	Ethernet (10/100/1000BaseT) RJ45
<b>Protocols</b>	EtherTalk; IPX/SPX(NDS); TCP/IP, HTTP, SNMP, IPP
<b>Printing Features</b>	Rip-While-Print; Continuous Print; Electronic Collation; Duplex; Sorting/Stapling; Booklet Printing; Thumbnail and Full Screen Preview (CWS); Job Merging/Editing (CWS); Fast Reprint; Media Server; Variable Data Printing
<b>Twain (Remote Scanning)</b>	and other scanning features
<b>PostScript Drivers</b>	Macintosh V.8.6 / 9.x / OS.x 10.2 or later Windows 95/98/2000/NT4/XP
<b>IP-901 Accessories</b>	
<b>FACI Kit</b>	Fiery Advance Controller Interface
<b>DocBuilder Pro Vers. 1.5</b>	Retro-compatible
<b>ES-1000</b>	EFI Photo Spectrometer for ICC Profiling
<b>ED-100</b>	EFI Densitometer
<b>GA Package</b>	Graphics Art Package

## DESIGNED FOR RECYCLING AND RE-USE

- Reusable electrical parts, including motor
- Parts made from recyclable plastic
- Double-sided tape that facilitates disassembly for reuse or recycling



## REDUCED EMISSIONS

Konica Minolta's exclusive Digital Toner offers advantages beside the improved imaging quality. Production of this polymerised toner reduces emissions of CO<sup>2</sup>, SO<sup>x</sup> and NO<sup>x</sup> by 40% compared to the production of conventional toners.

## EASY ON THE ENVIRONMENT

The Konica Minolta 8050 was designed with the same commitment to reducing environmental burden that goes into all of our business equipment. From developing new technologies to reduce energy consumption to creating parts that meet the strictest environmental guidelines.

With a slew of energy saving features like Power Saver mode, the Konica Minolta 8050 meets the guidelines established by the International Energy Star.

The Konica Minolta 8050 has achieved the highest international standards including the German Blue Angel mark, Nordic Swan, ISO and EPA certification.



Product appearance, configuration and/or specifications are subject to change without notice. Fiery is a registered trademark with the U.S. Patent and Trademark Office and certain other foreign jurisdictions. Fiery WebScan is a trademark of Electronics for Imaging, Inc. Windows TWAIN scanning is a registered trademark of Microsoft Corporation. PCL is a registered trademark or trademark of Hewlett-Packard Company. Adobe and PostScript are registered trademarks or trademarks of Adobe Systems Incorporated. All other brand and product names are registered trademarks or trademarks of their respective owners.